

SCHULZ *OF AMERICA, INC.*

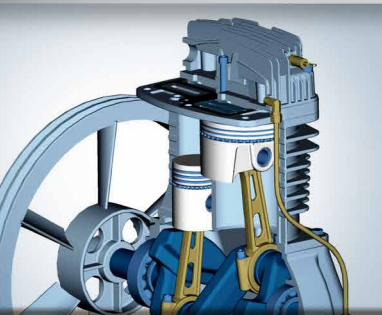

Compressor Pumps

The best in Cast Iron Compressors

Single Stage

MAX • 140PSI

- Splash oil lubricated pump
- Solid cast iron construction
- Large Swedish stainless steel reed valves
- Reversible head, right or left discharge
- Oversized crankcase for large oil capacity
- Product life up to 7,500 hours
- 1 stage



Model	Code	Motor	CFM Displacement	Max. Press.	Cyl. nr	Size (in)		rpm	Weight	Flywheel Size		Belt		FAD (CFM) @Max Press
		hp		psig		stroke	lbs		mm	in	n°	section		
MSI 5,2 ML	930.3416-0	1	5,2	140	1	2	1.26	2,275	13	160	6.30	1	3VX	2.5
CSV 10	809.1821-0	2	10	140	2	2	1.38	1,900	23	200	7.90	1	3VX	4.6
MSL 10 MAX	931.8090-0	2	10	140	2	2.5	1.85	860	40	254	10.00	1	A	5.0
MSL 15 MAX	932.3335-0	3	13	140	2	2.5	1.85	1,250	44	300	11.81	1	A	7.3
MSL 18 MAX	931.8095-0	4	18	140	2	3.0	1.85	1,190	42	300	11.81	1	A	5.4

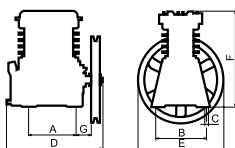

MODEL	A		B		C		D		E		F		G	
	mm	in	mm	in	mm	in	mm	in	mm	in	mm	in	mm	in
MSI 5.2 ML	40	1.575	134	5.276	11	0.433	150	5.906	175	6.890	240	9.449	55	2.165
CSV 10	98	3.858	149	5.866	17.8	0.701	246.9	9.720	335.7	13.216	289.1	11.382	103.5	4.075
MSL 10 MAX	140.5	5.531	149.5	5.886	10	0.394	285	11.220	254	10.000	282	11.102	21	0.827
MSL 15 MAX	140.5	5.531	149.5	5.886	10	0.394	285	11.220	300	11.811	282	11.102	21	0.827
MSL 18 MAX	140.5	5.531	149.5	5.886	10	0.394	307	12.086	300	11.811	302	11.889	60.5	2.381

OIL LESS • 120PSI

- Cast iron pump
- Large Swedish stainless steel reed valves
- Low maintenance
- Robust electric motor



Model	# of Stages	Code	Motor hp	CFM Displacement	Max. Press. psig	Cylinder nr	Size (in)		rpm	Weight lbs	Flywheel Size		Belt		FAD (CFM) @Max Press
							cylinder diameter	stroke			mm	in	n°	section	
MSV 6	1	931.1001-0	1	6	120	2	1.83	1.06	1,730	56	-	-	-	-	2.1
MSV 15	2	932.3383-0	3	15	120	2	3.54/2	3.35	620	97	420	16.54	1	A	6.6
MSW 60	2	934.7389-0	15	60	120	3	(2x) 4.75/3.54	2.75	880	320	540	21.26	2	B	37.6
CSD5	1	931.1307-0	1	5	120	2	(2x) 2.5	1.34	1,680	23.4	-	-	-	-	1.45
CSD9	1	931.1310-0	1.5	9	120	2	(2x) 2.5	1.65	1,680	38.8	-	-	-	-	3.7

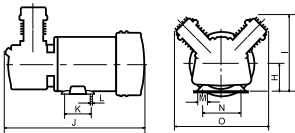

DIRECT DRIVEN	MODEL	H		I		J		K		L		M		N		O	
		mm	in	mm	in	mm	in	mm	in	mm	in	mm	in	mm	in	mm	in
		MSV 6	89	3.504	230	9.055	440	17.323	76	2.992	8.5	0.335	31	1.220	124	4.882	300

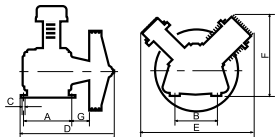

BELT DRIVEN	MODEL	A		B		C		D		E		F		G	
		mm	in	mm	in	mm	in	mm	in	mm	in	mm	in	mm	in
		MSV 15	140	5.512	224	8.819	10.5	0.413	405	15.945	420	16.535	429	16.890	98.5

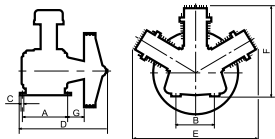

BELT DRIVEN	MODEL	A		B		C		D		E		F		G	
		mm	in	mm	in	mm	in	mm	in	mm	in	mm	in	mm	in
		MSW 60	218	8.600	320	12.600	14	0.600	550	21.600	740	29.100	620	24.500	120

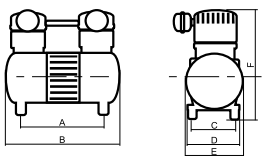

DIRECT DRIVEN	MODEL	A		B		C		D		E		F	
		mm	in	mm	in	mm	in	mm	in	mm	in	mm	in
		CSD 5	223	8.780	260	10.237	90	3.545	105	4.135	128	5.040	190
CSD 9	244	9.607	315	12.405	127	5.000	153	6.025	177	6.969	285	11.221	

Two Stage

● MAX "V" • 175PSI

- Solid cast iron construction
- Splash oil lubricated pump
- Large Swedish stainless steel reed valves
- Traditional V cylinder design
- Product life up to 7,500 hours
- 2 stages - better efficiency



Model	Code	Motor	CFM Displacement	Max. Press.	Cyl. nr	Size (in)		rpm	Weight lbs	Flywheel Size		Belt		FAD (CFM) @Max Press
		hp		psig		mm	stroke			mm	in	n°	section	
MSV 20 MAX	932.7527-0	5	20	175	2	3.543/2	3.346	1,050	97	420	16.54	1	A	15.7
MSV 30 MAX	933.1405-0	7.5	30	175	2	2.5/4.724	2.972	820	150	420	16.54	2	A	20.1
MSV 40 MAX	933.8000-0	10	37.5	175	2	2.5/4.724	2.972	1,240	174	500	19.69	2	A	25.8

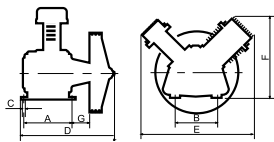

MODEL	A		B		C		D		E		F		G	
	mm	in	mm	in	mm	in	mm	in	mm	in	mm	in	mm	in
MSV 20 MAX	107	4.213	245	9.646	11	0.433	390	15.354	520	20.472	385	15.157	115	4.528
MSV 30 MAX	220	8.661	200	7.874	10.5	0.413	471	18.543	435	17.126	410	16.142	75	2.953
MSV 40 MAX	220	8.661	200	7.874	10.5	0.413	471	18.543	435	17.126	410	16.142	75	2.953

● MAX "L" • 175PSI

- Solid cast iron construction
- Splash oil lubricated pump
- Large Swedish stainless steel reed valves
- In line two cylinder design
- Product life up to 10,000 hours
- 2 stages - better efficiency



Model	Code	Motor	CFM Displacement	Max. Press.	Cyl. nr	Size (in)		rpm	Weight lbs	Flywheel Size		Belt		FAD (CFM) @Max Press
		hp		psig		mm	stroke			mm	in	n°	section	
MSL 20 MAX	932.7277-0	5	20	175	2	3.543/2	3.622	985	95	420	16.54	1	A	15.6
MSL 30 MAX	932.9312-0	7.5	30	175	2	2.5/4.724	3.622	820	144	420	16.54	2	A	21.6
MSL 40 MAX	932.9324-0	10	40	175	2	2.5/4.724	3.622	1,020	166	500	19.69	2	A	28.4

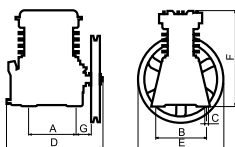

MODEL	A		B		C		D		E		F		G	
	mm	in	mm	in	mm	in	mm	in	mm	in	mm	in	mm	in
MSL 20 MAX	140	5.512	224	8.819	10.5	0.413	405	15.945	420	16.535	429	16.890	98.5	3.878
MSL 30 MAX	160	6.299	218	8.583	10.5	0.413	450	17.717	420	16.535	474	18.681	123.5	4.862
MSL 40 MAX	160	6.299	218	8.583	10.5	0.413	450	17.717	500	19.685	474	18.661	123.5	4.862

● MAX "W" • 175PSI

- Solid cast iron construction
- Splash oil lubricated pump
- Large Swedish stainless steel reed valves
- Finned Intercooler
- Three cylinder W design
- Product life up to 10,000 hours
- Large slow running pump
- 2 stages - better efficiency



Model	Code	Motor	CFM Displacement	Max. Press.	Cyl. nr	Size (in)		rpm	Weight	Flyweel Size		Belt		FAD (CFM)
		hp		psig		mm	stroke		lbs	mm	in	n°	section	@Max Press
MSW 60 MAX	933.9383-0	15	60	175	3	(2x) 4.75 / 3.543	2.755	1,065	276	500	19.69	2	B	45.0

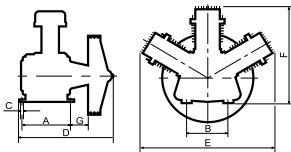

MODEL	A		B		C		D		E		F		G	
	mm	in	mm	in	mm	in	mm	in	mm	in	mm	in	mm	in
MSW 60 MAX	218	8.583	320	12.598	14	0.551	550	21.654	740	29.134	620	24.409	120	4.724

● MAX "WV" • 175PSI

- Solid cast iron construction
- Splash oil lubricated pump
- Large Swedish stainless steel reed valves
- Centrifugal Unloader
- Five cylinder WV design
- Product life up to 10,000 hours
- Large slow running pump
- 2 stages - better efficiency

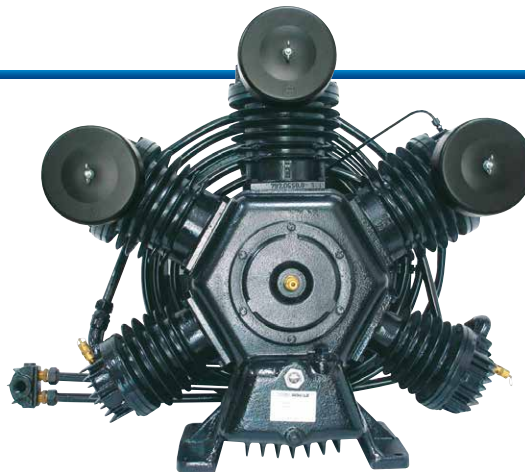

Model	Code	Motor	CFM Displacement	Max. Press.	Cyl. nr	Size (in)		rpm	Weight	Flyweel Size		Belt		FAD (CFM)
		hp		psig		mm	stroke		lbs	mm	in	n°	section	@Max Press
MSWV 80MAX	933.9385-0	20	80	175	5	2.5/3.543/(3x)4.75	2.755	910	366	540	21.26	2	B	58.4

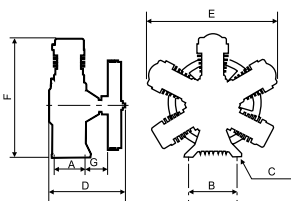

MODEL	A		B		C		D		E		F		G	
	mm	in	mm	in	mm	in	mm	in	mm	in	mm	in	mm	in
MSW 80 MAX	244	9.606	344	13.543	14	0.551	650	25.591	960	37.795	780	30.709	120	4.724

● BRAVO • 175PSI

- Solid cast iron construction
- Splash oil lubricated pump
- Large Swedish stainless steel reed valves
- Product life up to 10,000 hours
- Large slow running pump
- 2 stages - better efficiency



Model	Code	Motor hp	CFM Displacement	Max. Press. psig	Cyl. nr	Size (in)		rpm	Weight lbs	Flyweel Size		Belt		FAD (CFM) @Max Press
						cylinder diameter	stroke			mm	in	n°	section	
MSLV 60BR	924.3476-0	15	60	175	4	(2x) 2.5/(2x)4.724	3.622	820	290	540	21.26	2	B	45.2
MSLV 80BR	924.7352-0	20	80	175	4	(2x) 2.5/(2x)4.724	3.622	1,050	290	540	21.26	2	B	52.8

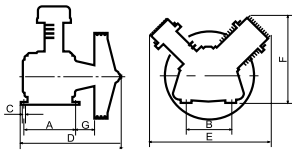

MODEL	A		B		C		D		E		F		G	
	mm	in	mm	in	mm	in	mm	in	mm	in	mm	in	mm	in
MSLV 60BR	190	7.480	368	14.488	24.6	0.968	571.7	22.508	758	2.984	5.726	2.254	165.3	6.508
MSLV 80BR	190	7.480	368	14.488	24.6	0.968	571.7	22.508	758	2.984	5.726	2.254	165.3	6.508



SCHULZ COMPRESSORS

Company History

Since 1963 in the market, Schulz is constantly improving. Using state of the art technology to achieve the competitiveness requested by the market. In the beginning, Schulz concentrated its activities on the foundry segment, and in 1972, Schulz began manufacturing air compressors.

What began as a line of only two air compressor models would soon turn into the largest and most complete line produced in Brazil. In 1984, Schulz products were made available through all of Latin America, Central America, and the USA.

Following this strategic development, in 1989 Schulz began the production of rotary screw compressors, competing in this segment with the biggest worldwide companies. In 1999, Schulz of America, Inc. was founded in Atlanta, Georgia with a warehouse, sales, and technical personnel who were trained at the head office in Joinville, Brazil. By doing this, Schulz definitively conquered it's share in the North American Market.

Currently, the company possesses modern industrial facilities with more than 667,000 ft2 of built up area where it develops diaphragm, reciprocating, and rotary screw compressors. Schulz continuously improves, perfecting production and testing processes and investing in staff development. Approved by the most demanding and rigorous international quality certification authorities, it is conquering important markets.

Today, Schulz is present in more than 60 countries, which reaffirms the excellence and the high technological standards of the product lines.

SCHULZ OF AMERICA, INC.

3420, Novis Pointe | Acworth | GA 30101
Phone # (770) 529.4731 | Fax # (770) 529.4733
orders@schulzamerica.com | www.schulzamerica.com



* Certificate of the Mark: Project, Development, Production and Sale of Air Compressors, Air Dryers and Compressed Air Pressure Vessels, Sale of Pneumatic Tools and Accessories for Compressed Air Equipment.
* Sistema de Gestión de la Calidad - Planta de Joinville. Certificado en Escape: Proyecto, Desarrollo, Fabricación y Venta de Compresores de Aire, Secadores de Aire y Conductos de Presión para Aire Comprimido.
Comercialización de Herramientas Neumáticas y Accesorios para equipamientos de Aire Comprimido. *



Certificates Available

